

BBF-10

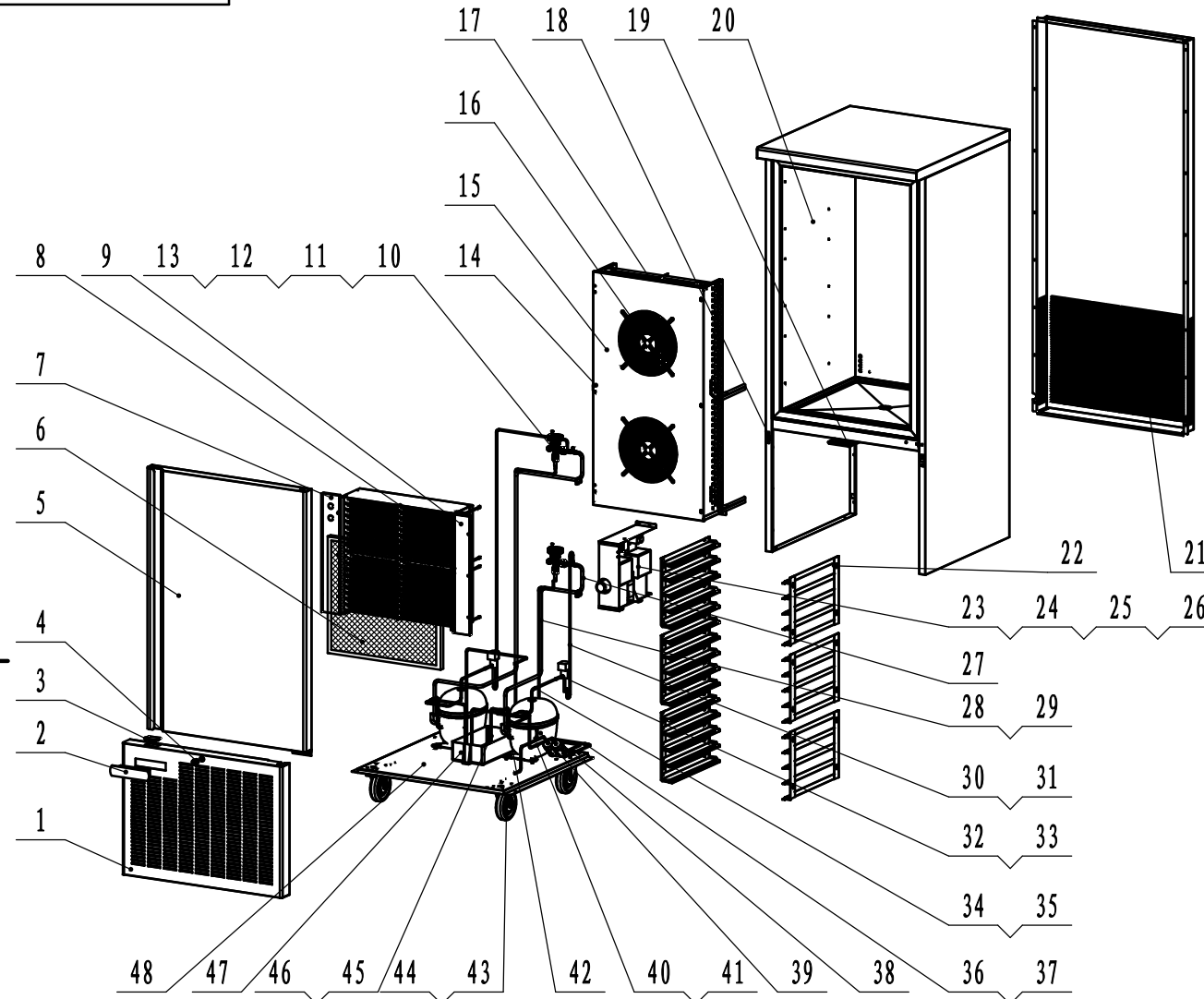

序号	代号	名称	数量	规格	备注
1	36570104	2019款10盘速冻柜前罩 Cow1 panel	1	SUS201-#4/0.8×907.3×618.5	
2	W0302312	速冻柜温控器 Controller	1	RoHS&REACH/PBB2COSCF0+easy blast chiller	
3	W0409162	门磁开关组件 Door Switch	1		
4	W0604007	冰箱锁 Door Lock	1		
5	36572001	10盘门壳组件 Door Assembly	1	SUS201-#4/55×748.5×798.1	
6	W0699115	冷凝器滤网 Air Filter	1	RoHS&REACH/铝合金边框/6.8,530×390,双层滤网20目	
7	36580130	2019款10盘速冻柜右挡风板 Right Windshield	1	镀锌板/0.5×416.8×87.4	
8	W020310601	翅片冷凝器R290(TP2M) Condenser	1	RoHS&REACH/翅片式/Φ6.52×0.6 4列15行/翅片392.5mm×100mm 欧款10盘速冻柜	
9	36580131	2019款10盘速冻柜左挡风板 Left Windshield	1	镀锌板/0.5×416.8×87.4	
10	W0206010	热力膨胀阀 Expansion valve	2	RoHS&REACH/TX2 R22/R407C 06873206 R22/R507C, -40/+10℃/-40/+50°F带纳子	
11	W0206011	膨胀阀阀芯 Spool	2	RoHS&REACH/DANFOSS 068-2010 No.01	
12	W0210518	170膨胀阀进口喇叭铜管 Connecting pipe	2	RoHS&REACH/铜管/TP2-M/Φ10×0.75/L=35mm/一端喇叭口Φ13.5另一端缩口至Φ6.5	
13	W0210675	喇叭口铜管 Connecting pipe	2	RoHS&REACH/外径/Φ12.7×0.75/TP2-M	
14	W060411801	不锈钢1.5寸合页 Hinge	5	RoHS&REACH/1.5寸/304/开孔尺寸25*19	
15	36570108	2019款10盘速冻柜蒸发器风机罩板 Evaporation fan cover plate	1	SUS304-#4/1.0×549.1×699.4	
16	R03001000096	外转子抽风风机(带304不锈钢平面罩) Evaporation fan	2	RoHS&REACH/220V/50Hz, 电流0.42A, 输入功率: 90W, 2400r/min, 风量1310m3/h, 电容3uF/450V/叶片250/微光	
17	W020224701	新款10盘速冻柜蒸发器-R290 Evaporator	1	RoHS&REACH/TP2M*9.52×0.41, 3排26列	
18	W0499776	面板扣(宴会车) Lock catch	2	塑料公扣, 塑料母扣, 不锈钢弹片	
19	36560405	S5盘速冻柜门引导 Door lock guide rail	1	镀锌板/1.5×113.7×123.6	
20	36572002	10盘箱体组件 Box Assembly	1		
21	36570127	2019款10盘速冻柜后背板R290 Back plate	1	镀锌板/0.8×868.2×1383.7	
22	36582003	滑槽组件 Chute assembly	4		
23		压缩机附件 Compressor accessories	2		
24		风机电容 Fan capacitance	3		
25	W0399138	200交流接触器 AC contactor	1	RoHS&REACH/200HC1 HCC-1XU02AAC 208/240VAC 50/60Hz	
26	36570126	E10盘速冻柜R290蒸发器进口管 Electrical box bracket	1	镀锌板/0.8×328.5×439.5	
27	W02108826	E10盘速冻柜R290机组1回气管 Connecting pipe	2	RoHS&REACH/铜管/TP2-M/Φ9.52×0.6/L=162mm	
28	W02108829	E10盘速冻柜R290机组2回气管 Connecting pipe	1	RoHS&REACH/铜管/TP2-M/Φ9.52×0.6/L=1926mm	
29	W02108830	E10盘速冻柜R290机组1热气管 Connecting pipe	1	RoHS&REACH/铜管/TP2-M/Φ9.52×0.6/L=1212mm	
30	W02108827	E10盘速冻柜R290机组2热气管 Connecting pipe	1	RoHS&REACH/铜管/TP2-M/Φ6×0.6/L=1221mm	
31	W02108828	E10盘速冻柜R290机组1过热器出口管 Connecting pipe	1	RoHS&REACH/铜管/TP2-M/Φ6×0.6/L=1367mm	
32	W0205024	电磁阀线圈[220V] Solenoid valve coil	2	三花电磁阀线圈规格: AC220~240V/52/60Hz/7W/5W	
33	W0205026	电磁阀阀体[常闭] Solenoid valve body	2	三花电磁阀 阀体: FDF6A	
34	W02108827	E10盘速冻柜R290机组1热气管 Connecting pipe	1	RoHS&REACH/铜管/TP2-M/Φ6×0.6/L=1221mm	
35	R02015001268	EBF-10机组1 热气管2 Connecting pipe	1	TP2-M/6mm/0.6mm/300/4.8	
36	W02108823	E10盘速冻柜R290机组1过滤器出口管 Connecting pipe	1	RoHS&REACH/铜管/TP2-M/Φ6×0.6/L=1859mm	
37	W02108824	E10盘速冻柜R290机组2过滤器出口管1 Connecting pipe	1	RoHS&REACH/铜管/TP2-M/Φ6×0.6/L=949mm	
38	W0204003	干燥过滤器 Drying filter	2	RoHS&REACH/2-IDΦ6.35×16/Φ42.5×65/XH-9 RoHS&REACH/R290/220-240V50Hz1PH/-23.3℃ 951.4W3.64ACOP1.61/CSCR/SECOP	
39	W0201799	R290压缩机 Compressor	2	E10盘速冻柜R290机组1冷凝器出口管	
40	W02108821	E10盘速冻柜R290机组2冷凝器出口管 Connecting pipe	1	RoHS&REACH/铜管/TP2-M/Φ6×0.6/L=374mm	
41	W02108822	E10盘速冻柜R290机组1冷凝器出口管 Connecting pipe	1	RoHS&REACH/铜管/TP2-M/Φ6×0.6/L=404mm	
42	W02108818	E10盘速冻柜R290排气管 Connecting pipe	2	RoHS&REACH/铜管/TP2-M/Φ6×0.6/L=290mm	
43	B060418915	5寸平底、方向、无刹车黑色脚轮 5-inch wheel	2		
44	B060418916	5寸平底、方向、带刹车黑色脚轮 5-inch wheel	2		
45	W02108819	E10盘速冻柜R290机组1散热管 Connecting pipe	1	RoHS&REACH/铜管/TP2-M/Φ6×0.6/L=1795mm	
46	W02108820	E10盘速冻柜R290机组2散热管 Connecting pipe	1	RoHS&REACH/铜管/TP2-M/Φ6×0.6/L=1833mm	
47	W0411152	注塑接水盘 Drip pan	1	RoHS&REACH/80x150x300/壁厚2mm/ABS	
48	36570129	2019款10盘速冻柜机组底板R290 Unit base plate	1	镀锌板/2.0×771×730.7	
49	W0302328	速冻柜无加热无源探针 Food probe	1	RoHS&REACH/无加热NTC型25℃10kΩBeta3435 上海魏数/NTC025HP00-C/SV/W0302201 (前:RoHS&REACH/线长2.5米)	
50	W0302201	2.5米电子温控器探头 Temperature probe	2		

					组件			物料编号:	
					展开尺寸:			欧款速冻柜	
					程序编号:				
标记	处数	分区	更改文件号	签名	年、月、日	阶段标记		重量(KG) 比例	
设计						S		1:20	
审核								EBF-10	
工艺						共 1 张 第 1 张		版本号: a1	



欧款速冻柜
爆炸图
EBF-10